

# POPOP STRAIGHT 10'



\*Optional 200 watt halogen lights



\*Package includes padded nylon travel bag

## Graphic Specification

Graphic Size: 141.50W "x 88.98H" ( includes 11.81" end panels on both sides)

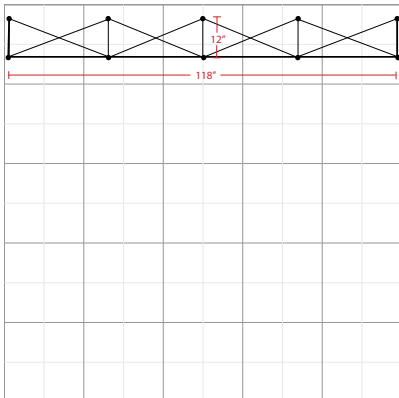

The box represents 10' x 10' booth.

## Product Features

Our ultra lightweight aluminum alloy fabric pop-up display in a matte satin anodized finish is an ideal eye-catcher for your trade show, exhibition, or conference. Its versatility and simple 2-minute setup, as well as its Velcro attachment, makes it functional for special events as well as an in-office promotional tool for walk-in customers. Another convenient feature is that your graphic stays attached in your free travel/carry bag that comes with each frame you purchase.

Graphic Size	141.5"W x 88.98"H
Display Size	118"W x 89"H x 12"D

## Finishing

2" loop Velcro perimeter

Printing Material	Polyester Fabric
-------------------	------------------

## Construction

Aluminum Frame

2" Hook Velcro Strips

Plastic Hooks

## Weights - Dimensions

Shipping Weight	42lbs
Shipping Dimensions	36" x 18" x 16"

## Parts List

(1) Aluminum Frame	(1) Padded Nylon Bag with drawstring
(1) Digital Print on Fabric w/ End Panels	(1) Wheel Frame for Carry Bag